

LANDUSE STATEMENT RAJARHAT HOUSING COMPLEX			
DETAILS	VALUE	UNIT	%
LAND AREA	35046.54	sqm	100.00
GROUND COVERAGE	11246.04	sqm	32.09
SERVICE AREA	2675.32	sqm	7.63
PAVED AREA	9413.47	sqm	26.86
EXCLUSIVE TREE PLANTATION AREA	7075.30	sqm	20.19
FUTURE EXPANSION AREA	3761.62	sqm	10.73
OPEN PARKING AREA	874.79	sqm	2.50
TOTAL	35046.54	sqm	100.00

**AREA STATEMENT:-**

STATEMENT OF THE PLAN PROPOSAL	15046.54 Sqm
1. AREA OF LAND	15046.54 Sqm
2. PROPOSED AREA OF LAND	15046.54 Sqm
3. UNRECOVERABLE BUILDING COVERAGE AREA	13776.54 Sqm
4. PROPOSED GROUND COVERAGE - (20%)	3749.54 Sqm
5. PERMISSIBLE HEIGHT - (20M)	74.33 M (AS PER PLAN)
6. PROPOSED HEIGHT -	61.35 M
7. AVERAGE ROAD WIDTH -	27.00 M
8. PERMISSIBLE F.A.R. -	1.50
9. PERMISSIBLE FAR BUILT UP AREA - (20000/15) SQM	13333.33 Sqm

FLOOR	TOTAL COVERED AREA	OUT OUT	PRESTRESSER LIFT	STAR WAY	NET FLOOR AREA	BUILT-UP AREA
GROUND FLOOR	1193.20	54.00	88.24	85.08	1300.52	1300.52
BLOCK 1	1464.81	36.00	61.51	57.66	1619.87	1619.87
BLOCK 2	2007.53	35.00	53.58	50.55	2146.56	2146.56
BLOCK 3	2007.53	35.00	53.58	50.55	2146.56	2146.56
TOWER A	4483.40	37.57	54.00	50.82	4585.65	4585.65
TOWER B	3393.88	34.57	38.00	41.51	3402.40	3402.40
TOWER C	2348.45	17.50	30.00	30.38	2356.50	2356.50
TOWER D	4012.75	42.78	54.00	50.82	4109.67	4109.67
TOWER E	3393.88	34.57	38.00	41.51	3402.40	3402.40
TOWER F	2481.62	20.78	30.00	30.38	2491.68	2491.68
TOWER G	302.85	78.54	18.00	30.34	363.59	363.59
TOWER H	1204.45	18.54	25.00	40.18	1248.16	1248.16
TOWER I	664.38	75.11	18.00	30.34	769.83	769.83
TOWER J	871.85	18.78	18.00	30.34	920.87	920.87
TOWER K	578.39	29.00	18.00	30.34	637.73	637.73
TOWER L	402.85	29.00	18.00	30.34	462.19	462.19
TOWER M	800.701	30.85	18.00	30.34	861.951	861.951
TOWER N	1100.80	40.85	25.00	40.18	1151.79	1151.79
TOWER O	762.81	39.81	18.00	30.34	812.82	812.82
TOWER P	770.57	82.78	18.00	30.34	881.67	881.67
TOWER Q	600.701	30.85	18.00	30.34	661.951	661.951
TOWER R	718.84	44.61	18.00	30.34	793.79	793.79
TOWER S	718.84	44.61	18.00	30.34	793.79	793.79
TOWER T	1100.80	40.85	25.00	40.18	1151.79	1151.79
TOWER U	871.85	18.78	18.00	30.34	920.87	920.87
TOWER V	653.84	31.19	18.00	30.34	715.37	715.37
TOWER W	312.75	18.57	18.00	30.34	351.66	351.66
TOWER X	419.88	27.83	18.00	30.34	458.09	458.09
TOWER Y	749.47	27.47	25.00	40.18	807.12	807.12
TOWER Z	376.21	18.57	18.00	30.34	425.15	425.15
TOWER AA	322.65	27.87	18.00	31.19	380.71	380.71
TOWER AB	721.75	27.88	25.00	40.18	779.71	779.71
TOWER AC	322.65	27.87	18.00	31.19	380.71	380.71
TOWER AD	322.65	27.87	18.00	31.19	380.71	380.71
TOWER AE	371.57	27.82	18.00	31.19	429.56	429.56
TOWER AF	802.180	32.48	25.00	40.18	864.84	864.84
TOWER AG	371.57	27.82	18.00	31.19	429.56	429.56
TOTAL AREA	11177.58	748.27	2480.00	4265.04	11976.77 (F.A.R. MAX)	11976.77
TOTAL BUILT-UP AREA						104715.16
TOTAL MUMTY AREA						482.80
TOTAL CLIP BOARD AREA						1621.95
						15847.71

REQUIREMENTS & CAR PARKING CALCULATION	NO. OF TOWER	CAR PARKING AS PER RULES	REQUIRED CAR PARKING	TOTAL PARKING AREA PROVIDED
RECOMMENDATION				
25 Sep - 100 Sep	178	1 CAR PARKING SPACE FOR EVERY TWO OCCUPANTS	89	89
100 Sep - 200 Sep	497	1 PARKING FOR LIFT	497	497
>200 Sep	3	1 PARKING FOR TWO ROOM AND ONE CAR PARKING FOR EVERY ADDITIONAL 100 SQM	6	2186.71 Sqm
NON-RESIDENTIAL	078		627	
ASSEMBLY TOTAL COVERED AREA - 30.08 SQM & TOTAL GARAGE AREA - 188.88 SQM			11	
TOTAL CAR PARKING REQUIRED			894	

TYPE OF TOWER	NO.
2.8M	218
3.3M	220
3.8M	225
4.3M	230
4.8M	235
5.3M	240
5.8M	245
6.3M	250
6.8M	255
7.3M	260
TOTAL	2778

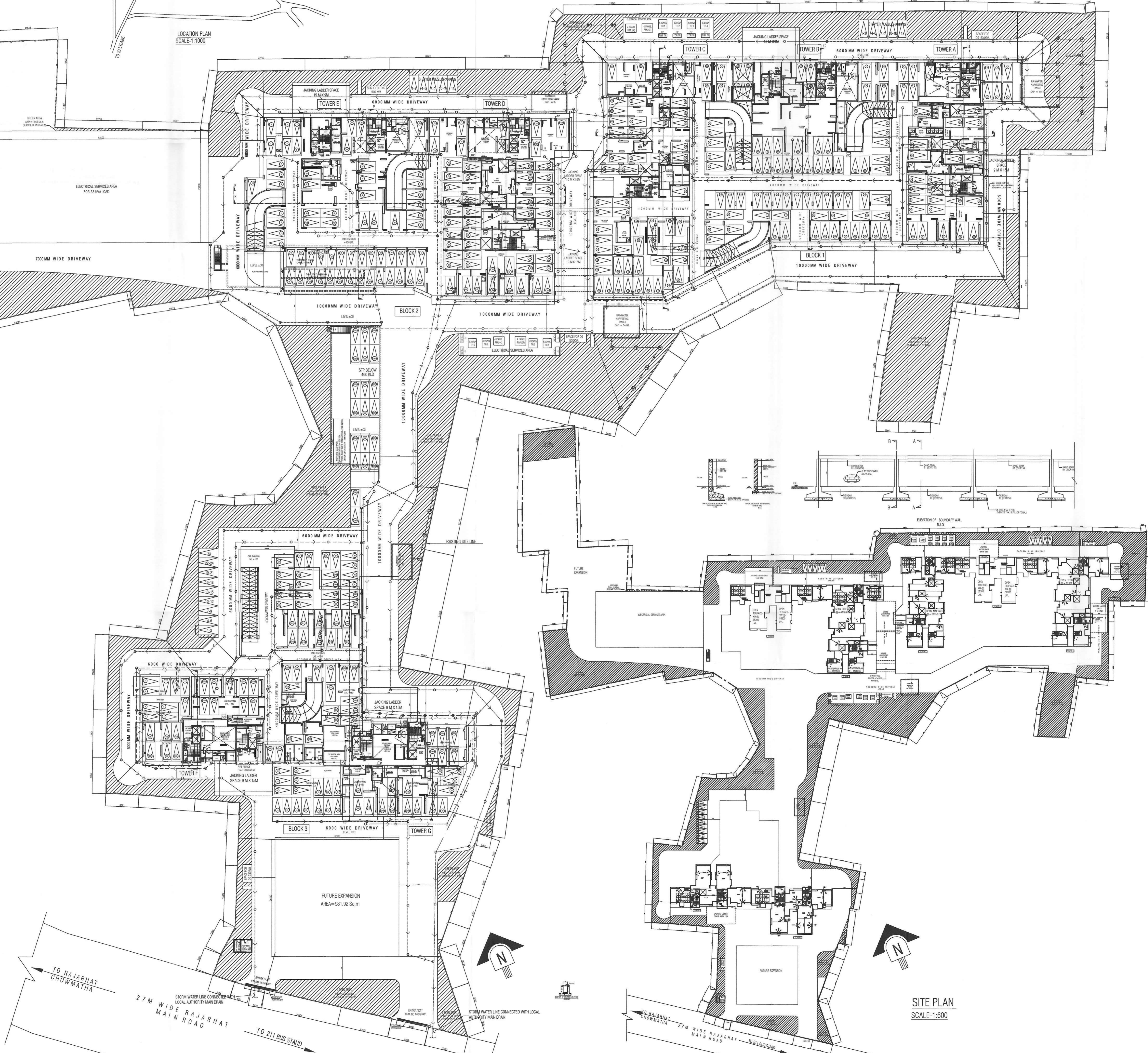

SCHEDULE OF DOORS & WINDOWS											
DOORS:						WINDOWS:					
MKD	WIDTH	HEIGHT	SILL	LINTEL	MKD	WIDTH	HEIGHT	SILL	LINTEL		
D1	1200	2300	00	2300	W1	1500	1850	350	2300		
D2	1000	2300	00	2300	W2	1200	1850	350	2300		
D3	800	2300	00	2300	W3	1000	1850	350	2300		
D4	600	1100	1200	2300	W4	900	1950	350	2300		
D5	1100	2300	00	2300	W5	900	1950	350	2300		
D6	1000	2300	00	2300	W6A	900	1250	1950	2300		
D7	750	1800	00	1800	W4	600	1950	350	2300		
D8	2100	2300	00	2300	W6	450	1950	350	2300		
D9	1800	2300	00	2300	W5	740	1950	350	2300		
D10	1500	2300	00	2300	W7	500	1950	350	2300		
D11	1200	2300	00	2300	W8	450	1950	350	2300		
D12	1100	2300	00	2300	W9	450	1950	350	2300		
D13	1000	2300	00	2300	W10	450	1950	350	2300		
D14	900	2300	00	2300	W11	450	1950	350	2300		
D15	800	2300	00	2300	W12	450	1950	350	2300		
D16	700	2300	00	2300	W13	450	1950	350	2300		
D17	600	2300	00	2300	W14	450	1950	350	2300		
D18	500	2300	00	2300	W15	450	1950	350	2300		
D19	400	2300	00	2300	W16	450	1950	350	2300		
D20	300	2300	00	2300	W17	450	1950	350	2300		
D21	200	2300	00	2300	W18	450	1950	350	2300		
D22	100	2300	00	2300	W19	450	1950	350	2300		
D23	0	2300	00	2300	W20	450	1950	350	2300		

- NOTES:
- ALL DIMENSIONS ARE IN MM. UNLESS OTHERWISE MENTIONED.
  - ALL EXTERNAL WALLS ARE 150 THK & INTERNAL WALLS ARE 125 THK. IF NOT STATED IN 1:4 CORNER SAND MORTAR.
  - ALL ELEVATION PROJECTIONS ARE 500 MM. PROJECTED.
  - DEPTH OF UNDERGROUND WATER RESERVOIR SHOULD NOT EXCEED THE DEPTH OF FOUNDATION.
  - ANY DISCREPANCY IN SCALE, THE WRITTEN DIMENSION SHALL GOVERN.
  - FOR SPECIFICATION OF MATERIALS & WORKMANSHIP N.B.C. 2016 TO BE FOLLOWED.
  - OPEN STRUCTURE WITH LAME TERRACING OF RATIO 2:1.
  - FLY ASH AND FLY ASH BASED MATERIAL WILL BE USED IN THE PROJECT.
  - SOLAR ENERGY OF 2% OF THE CONNECTED LOAD WILL BE USED IN THIS PROJECT.
  - IS 15986, IS 8011, IS 8012, IS 8013, IS 8014, IS 8015, IS 8016, IS 8017, IS 8018, IS 8019, IS 8020, IS 8021, IS 8022, IS 8023, IS 8024, IS 8025, IS 8026, IS 8027, IS 8028, IS 8029, IS 8030, IS 8031, IS 8032, IS 8033, IS 8034, IS 8035, IS 8036, IS 8037, IS 8038, IS 8039, IS 8040, IS 8041, IS 8042, IS 8043, IS 8044, IS 8045, IS 8046, IS 8047, IS 8048, IS 8049, IS 8050, IS 8051, IS 8052, IS 8053, IS 8054, IS 8055, IS 8056, IS 8057, IS 8058, IS 8059, IS 8060, IS 8061, IS 8062, IS 8063, IS 8064, IS 8065, IS 8066, IS 8067, IS 8068, IS 8069, IS 8070, IS 8071, IS 8072, IS 8073, IS 8074, IS 8075, IS 8076, IS 8077, IS 8078, IS 8079, IS 8080, IS 8081, IS 8082, IS 8083, IS 8084, IS 8085, IS 8086, IS 8087, IS 8088, IS 8089, IS 8090, IS 8091, IS 8092, IS 8093, IS 8094, IS 8095, IS 8096, IS 8097, IS 8098, IS 8099, IS 8100, IS 8101, IS 8102, IS 8103, IS 8104, IS 8105, IS 8106, IS 8107, IS 8108, IS 8109, IS 8110, IS 8111, IS 8112, IS 8113, IS 8114, IS 8115, IS 8116, IS 8117, IS 8118, IS 8119, IS 8120, IS 8121, IS 8122, IS 8123, IS 8124, IS 8125, IS 8126, IS 8127, IS 8128, IS 8129, IS 8130, IS 8131, IS 8132, IS 8133, IS 8134, IS 8135, IS 8136, IS 8137, IS 8138, IS 8139, IS 8140, IS 8141, IS 8142, IS 8143, IS 8144, IS 8145, IS 8146, IS 8147, IS 8148, IS 8149, IS 8150, IS 8151, IS 8152, IS 8153, IS 8154, IS 8155, IS 8156, IS 8157, IS 8158, IS 8159, IS 8160, IS 8161, IS 8162, IS 8163, IS 8164, IS 8165, IS 8166, IS 8167, IS 8168, IS 8169, IS 8170, IS 8171, IS 8172, IS 8173, IS 8174, IS 8175, IS 8176, IS 8177, IS 8178, IS 8179, IS 8180, IS 8181, IS 8182, IS 8183, IS 8184, IS 8185, IS 8186, IS 8187, IS 8188, IS 8189, IS 8190, IS 8191, IS 8192, IS 8193, IS 8194, IS 8195, IS 8196, IS 8197, IS 8198, IS 8199, IS 8200, IS 8201, IS 8202, IS 8203, IS 8204, IS 8205, IS 8206, IS 8207, IS 8208, IS 8209, IS 8210, IS 8211, IS 8212, IS 8213, IS 8214, IS 8215, IS 8216, IS 8217, IS 8218, IS 8219, IS 8220, IS 8221, IS 8222, IS 8223, IS 8224, IS 8225, IS 8226, IS 8227, IS 8228, IS 8229, IS 8230, IS 8231, IS 8232, IS 8233, IS 8234, IS 8235, IS 8236, IS 8237, IS 8238, IS 8239, IS 8240, IS 8241, IS 8242, IS 8243, IS 8244, IS 8245, IS 8246, IS 8247, IS 8248, IS 8249, IS 8250, IS 8251, IS 8252, IS 8253, IS 8254, IS 8255, IS 8256, IS 8257, IS 8258, IS 8259, IS 8260, IS 8261, IS 8262, IS 8263, IS 8264, IS 8265, IS 8266, IS 8267, IS 8268, IS 8269, IS 8270, IS 8271, IS 8272, IS 8273, IS 8274, IS 8275, IS 8276, IS 8277, IS 8278, IS 8279, IS 8280, IS 8281, IS 8282, IS 8283, IS 8284, IS 8285, IS 8286, IS 8287, IS 8288, IS 8289, IS 8290, IS 8291, IS 8292, IS 8293, IS 8294, IS 8295, IS 8296, IS 8297, IS 8298, IS 8299, IS 8300, IS 8301, IS 8302, IS 8303, IS 8304, IS 8305, IS 8306, IS 8307, IS 8308, IS 8309, IS 8310, IS 8311, IS 8312, IS 8313, IS 8314, IS 8315, IS 8316, IS 8317, IS 8318, IS 8319, IS 8320, IS 8321, IS 8322, IS 8323, IS 8324, IS 8325, IS 8326, IS 8327, IS 8328, IS 8329, IS 8330, IS 8331, IS 8332, IS 8333, IS 8334, IS 8335, IS 8336, IS 8337, IS 8338, IS 8339, IS 8340, IS 8341, IS 8342, IS 8343, IS 8344, IS 8345, IS 8346, IS 8347, IS 8348, IS 8349, IS 8350, IS 8351, IS 8352, IS 8353, IS 8354, IS 8355, IS 8356, IS 8357, IS 8358, IS 8359, IS 8360, IS 8361, IS 8362, IS 8363, IS 8364, IS 8365, IS 8366, IS 8367, IS 8368, IS 8369, IS 8370, IS 8371, IS 8372, IS 8373, IS 8374, IS 8375, IS 8376, IS 8377, IS 8378, IS 8379, IS 8380, IS 8381, IS 8382, IS 8383, IS 8384, IS 8385, IS 8386, IS 8387, IS 8388, IS 8389, IS 8390, IS 8391, IS 8392, IS 8393, IS 8394, IS 8395, IS 8396, IS 8397, IS 8398, IS 8399, IS 8400, IS 8401, IS 8402, IS 8403, IS 8404, IS 8405, IS 8406, IS 8407, IS 8408, IS 8409, IS 8410, IS 8411, IS 8412, IS 8413, IS 8414, IS 8415, IS 8416, IS 8417, IS 8418, IS 8419, IS 8420, IS 8421, IS 8422, IS 8423, IS 8424, IS 8425, IS 8426, IS 8427, IS 8428, IS 8429, IS 8430, IS 8431, IS 8432, IS 8433, IS 8434, IS 8435, IS 8436, IS 8437, IS 8438, IS 8439, IS 8440, IS 8441, IS 8442, IS 8443, IS 8444, IS 8445, IS 8446, IS 8447, IS 8448, IS 8449, IS 8450, IS 8451, IS 8452, IS 8453, IS 8454, IS 8455, IS 8456, IS 8457, IS 8458, IS 8459, IS 8460, IS 8461, IS 8462, IS 8463, IS 8464, IS 8465, IS 8466, IS 8467, IS 8468, IS 8469, IS 8470, IS 8471, IS 8472, IS 8473, IS 8474, IS 8475, IS 8476, IS 8477, IS 8478, IS 8479, IS 8480, IS 8481, IS 8482, IS 8483, IS 8484, IS 8485, IS 8486, IS 8487, IS 8488, IS 8489, IS 8490, IS 8491, IS 8492, IS 8493, IS 8494, IS 8495, IS 8496, IS 8497, IS 8498, IS 8499, IS 8500, IS 8501, IS 8502, IS 8503, IS 8504, IS 8505, IS 8506, IS 8507, IS 8508, IS 8509, IS 8510, IS 8511, IS 8512, IS 8513, IS 8514, IS 8515, IS 8516, IS 8517, IS 8518, IS 8519, IS 8520, IS 8521, IS 8522, IS 8523, IS 8524, IS 8525, IS 8526, IS 8527, IS 8528, IS 8529, IS 8530, IS 8531, IS 8532, IS 8533, IS 8534, IS 8535, IS 8536, IS 8537, IS 8538, IS 8539, IS 8540, IS 8541, IS 8542, IS 8543, IS 8544, IS 8545, IS 8546, IS 8547, IS 8548, IS 85

